

**Attachment 1**  
**Package RTL-11**  
**Released: 9-29-17**

**Package Summary**

<b>Space Identifier</b>	<b>Near Gate</b>	<b>Proposed Concept</b>	<b>Square Footage</b>	<b>Term in Years</b>
C-2-024D-A01	C06	Candy	511	7

<b>Product Description</b>	<b>Bid Range</b>	<b>Proposed</b>
Specialty Retail	16% - 19%	
Allowances - Display/Fixture Allowances, Performance Allowances, Promotional Allowances, Retail Display Allowances (RDAs) and Special Purchase Allowances	11% - 14%	
<b>Minimum Annual Guarantee</b>	\$110,000	XXXXXXXXXX

**CATEGORY - Specialty Retail**

Retail other than Convenience Retail, including shops specializing in books, clothing, fashion accessories, shoes, electronics, sports apparel, jewelry, local crafts, packaged foods for consumption off-premises, and gift/souvenir shops, among others.

**Concept Description:**

The location must carry a variety of different candies, such as high-end chocolates or nostalgic confectioneries that will enhance the customer experience. The location may also revolve around a specific type of candy, such as chocolate, taffy, or fudge. The location design should reflect a fun, inviting atmosphere. This concept should offer an engaging atmosphere to include online purchasing and passenger interaction such as sampling.

**PROPOSER'S ACKNOWLEDGEMENT FOR PACKAGE RTL-11**

**Name and Title of Signer:** \_\_\_\_\_  
 (Print or Type)

**Signature:** \_\_\_\_\_ **Date:** \_\_\_\_\_

**Attachment 1**  
Package RTL-11  
Released: 9-29-17  
Package RTL-11 (continuation)

**Minimum Requirements:**

1. Must carry an assortment of candies appealing to our global customers and gift items.
2. The location should also provide staff with the ability to conduct sales transactions using hand-held credit-card processing devices or other form of technology to ensure speed of service.
3. This concept may offer bottled beverages allowable in accordance with the lease.

**Desired Elements:**

1. Online ordering

**Design Requirements:**

1. All existing finishes should be replaced with new finishes. The storefront openings should be modified to match the LOD. The electrical service location may need to be relocated to accommodate the new layout and/or comply with applicable codes. Existing electrical HVAC equipment and other infrastructure may be utilized if adequate for new concept, and in good working order. The successful proposer will need to add water and sanitary sewer. The design should be unique and inviting and should have an iconic appeal. Design of the space should reflect a bold, theme with a contemporary aesthetic that generates national appeal. Tenant will be responsible for bringing some utilities to the space from nearest tie-in point which may be outside of the LOD.
2. Display of the products should be appetizing and appealing.
3. Refer to the Tenant Design Manual

**PACKAGE ACDBE/M/WBE Goals:**

Area	Goal	Proposed
ACDBE	45%	
M/WBE	30%	

**For more information on ACDBE/M/WBE requirements, see section 2.4 of the RFP.**

\*Although offered as a package each location will have their own independent lease.

**GENERAL NOTES:**

1. ALL DIMENSIONS TO BE FIELD VERIFIED WITH AS-BUILT CONDITIONS AND COORDINATED WITH ALL WALL TYPES
2. OVERHEAD MEP AND STRUCTURAL CONDITIONS VARY. TENANT TO FIELD VERIFY AND CONFIRM ALL AS-BUILT CONDITIONS.
3. REFER TO CONCESSIONS SERVICE MATRIX 7.6 FOR MEP AND STRUCTURAL CONDITIONS RELATIVE TO LEASE SPACE

**LEASE OUTLINE LOCATION STANDARDS:**

1. BETWEEN DEMISED CONCESSION UNITS LEASE LINE IS LOCATED ON THE CENTERLINE OF DEMISING WALLS.
2. BETWEEN CONCESSION UNITS AND HOLD LOUNGE AREAS LEASE LINE IS LOCATED ON THE HOLD LOUNGE SIDE OF THE DEMISING WALL.
3. FACING CONCOURSE CIRCULATION LEASE LINE IS LOCATED AT THE OUTSIDE FACE OF GLAZING SYSTEM.
4. FACING AIRFIELD LEASE LINE IS LOCATED AT THE OUTSIDE FACE OF GLASS.
5. TERMINAL TERRAZZO TO BE PROTECTED BY TENANT

THIS LEASE OUTLINE DRAWING IS PRELIMINARY AND IS INTENDED TO PROVIDE A BASIC ARCHITECTURAL CHARACTERISTICS, APPROXIMATE DIMENSIONS AND OVERALL AREA OF SHELL LEASE SPACE. INFORMATION CONTAINED WITHIN IS SUBJECT TO CHANGE WITHOUT NOTICE. AS STATED IN GENERAL NOTES 1 AND 2, TENANT IS REQUIRED TO FIELD VERIFY ALL EXISTING CONDITIONS PRIOR TO COMMENCEMENT OF DESIGN WORK.

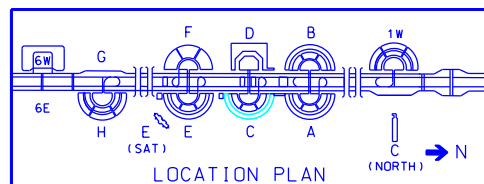
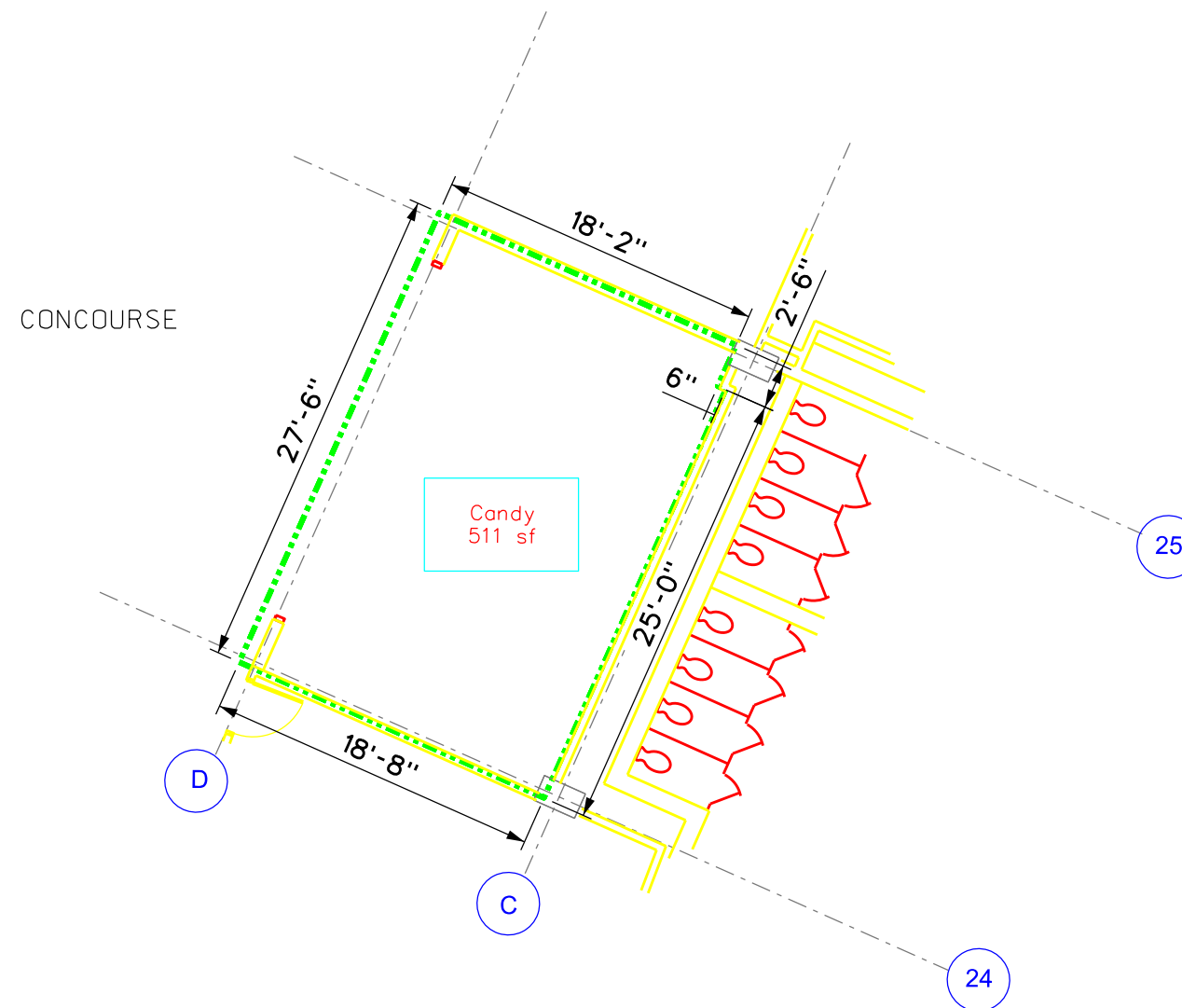

**DALLAS / FORT WORTH INTERNATIONAL AIRPORT**

DRAWN BY: TDP  
 APPROVED BY:  
 ISSUE DATE: 09.12.2017

TYPE OF USE: RETAIL  
 TERMINAL LOCATION: TERMINAL C  
 REFERENCE NUMBER: C-2-024D-A01 GATE: 06  
 DESIGN CONDITION:  
 CONTRACT NUMBER: 238823



SHEET NUMBER